

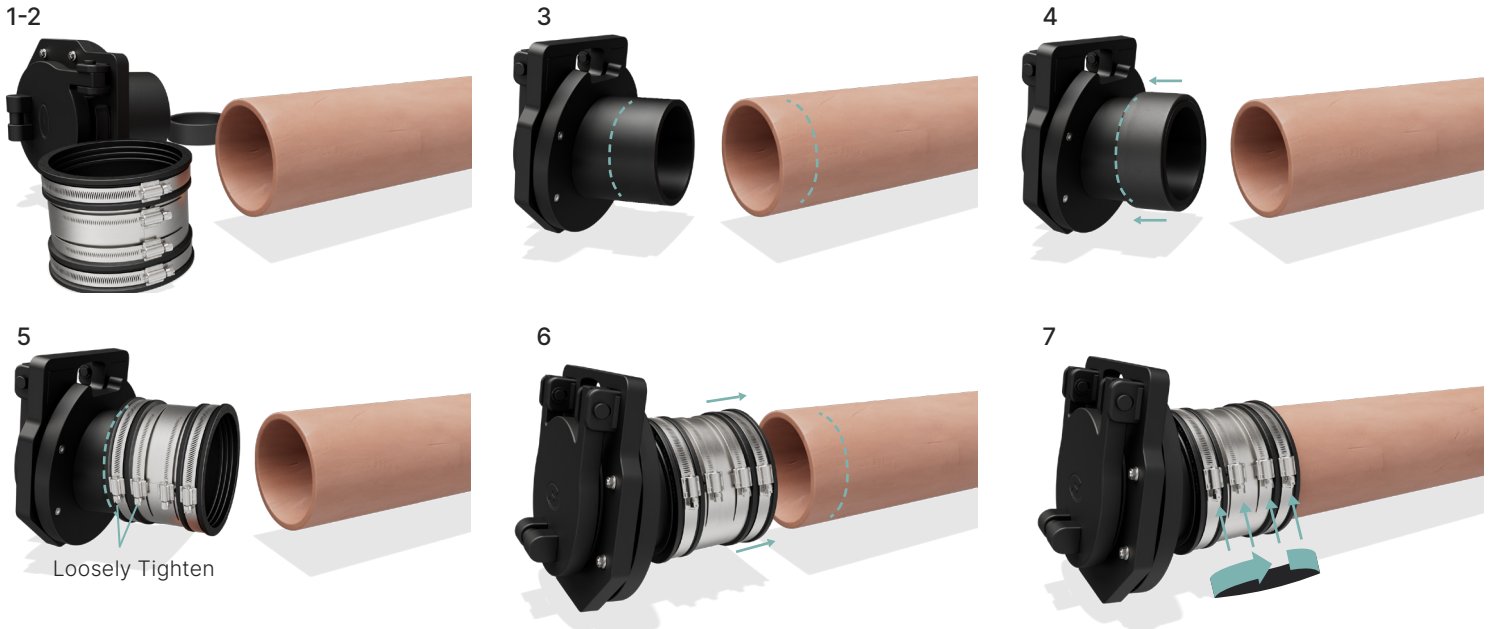

Spigot Mount Flap Valve Instructions



Scan for
Installation Video



Installation Guide

1. Ensure the pipe has a straight, square end.
2. Clean the outside surface of the pipe so it's smooth and free of dirt, scale, or debris—this helps the coupling seal properly.
3. Measure the coupling width and mark half of that measurement on both the Flap Valve spigot and the connecting pipe.
4. If using a bushing, slide the bushing onto the Flap Valve spigot until the edge of the bushing is flush with the marked line.
5. Slide the Fernco Strong Back RC coupling over the bushing until the end faces are flush, then hand-tighten the end clamp. If no bushing is required, slide the Strong Back RC coupling onto the spigot until the edge of the coupling is flush with the marked line, then hand-tighten the end clamp.
6. Butt the Flap Valve spigot up to the main pipe. The coupling should now align with the line previously marked on the pipe. Confirm the Flap Valve is oriented correctly (hinge mechanism at the 12 o'clock position), then hand-tighten the remaining end clamp.
7. Tighten all clamp bands to the recommended torque (see coupling label), tightening in sequence across the width of the coupling and starting with the center shear band.

Pipe Material Connection Types

- ABS
- Cast Iron
- Clay
- Concrete
- Corrugated Polyethylene
- Ductile Iron
- HDPE
- SCH. 40 PVC
- SDR-35 PVC
- Steel
- Western Clay

PLEASE NOTE: Spigot mount flap valve selection requires pipe OD and ID. Please confirm both and have them available when contacting Fernco so the correct valve configuration can be specified.



Spigot Mounted Flap Valves

Technical Specifications

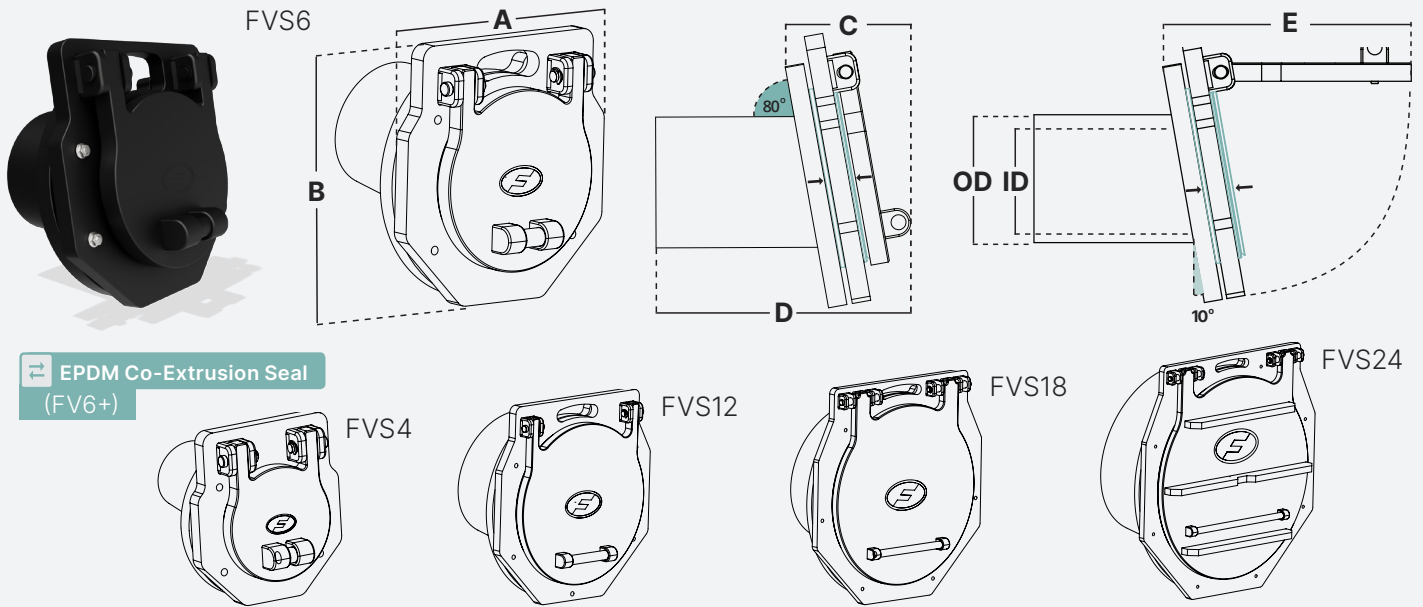

Product Code	Pipe Size (in)	Spigot OD (in)	Spigot ID (in)	A (in)	B (in)	C (in)	D (in)	E (in)	Head Pressure (ft)	Weight (lbs)
FVS4	4	4.33	4.00	8.32	9.23	4.91	10.50	9.10	25.0	6.10
FVS6	6	6.30	5.81	10.78	11.43	5.16	10.85	10.83	25.0	10.10
FVS8	8	8.86	8.31	13.39	13.72	5.61	11.08	12.86	25.0	16.30
FVS10	10	11.02	10.35	14.90	15.40	5.35	11.63	14.78	25.0	19.50
FVS12	12	12.40	11.80	16.87	17.39	6.16	11.77	16.71	25.0	23.70
FVS14-1*	14	13.98	13.11	21.40	22.22	6.69	12.27	21.41	25.0	22.05
FVS14-2*	14	15.75	14.76	21.40	22.22	6.69	12.27	21.41	25.0	28.66
FVS15*	15	15.75	14.76	21.40	22.22	6.69	12.27	21.41	25.0	28.66
FVS16-1*	16	15.75	14.76	21.40	22.22	6.69	12.27	21.41	25.0	28.66
FVS16-2*	16	17.72	16.61	23.37	24.19	7.02	14.56	23.49	25.0	33.07
FVS18-1*	18	17.72	16.61	23.37	24.19	7.02	14.56	23.49	25.0	33.07
FVS18-2*	18	19.69	18.46	25.53	26.26	7.23	14.41	25.48	25.0	39.68
FVS20-1*	20	19.69	18.46	25.53	26.26	7.23	14.41	25.48	25.0	39.68
FVS20-2*	20	22.05	20.67	29.67	30.30	7.31	14.94	26.51	25.0	44.09
FVS21*	21	22.05	20.67	29.67	30.30	7.31	14.94	26.51	25.0	44.09
FVS24*	24	24.80	23.27	30.65	31.28	7.49	14.64	29.27	25.0	57.32

* **Special Order:** Lead time and minimum quantities may apply—confirm at time of order.

Spigot Mount: Specify Required Coupling

Spigot mount flap valves are sold separately from the **Fernco Strong Back RC shielded coupling** required to complete the installation and provide a rigid, shear-resistant connection at the pipe end. Coupling selection is based on the pipe's outside diameter (OD), with pipe material used for confirmation. Select sizes 14" and larger are offered in separate versions to accommodate the OD differences between iron pipe (IPS) and ductile iron pipe (DIPS). When contacting Fernco, reference the individual cut sheets and provide pipe OD, ID, and material so the correct valve and coupling configuration can be specified for purchase through distribution.

